

GEMEINDE GAUKÖNIGSHOFEN – BEBAUUNGSPLAN "HIRTENPFAD 2"

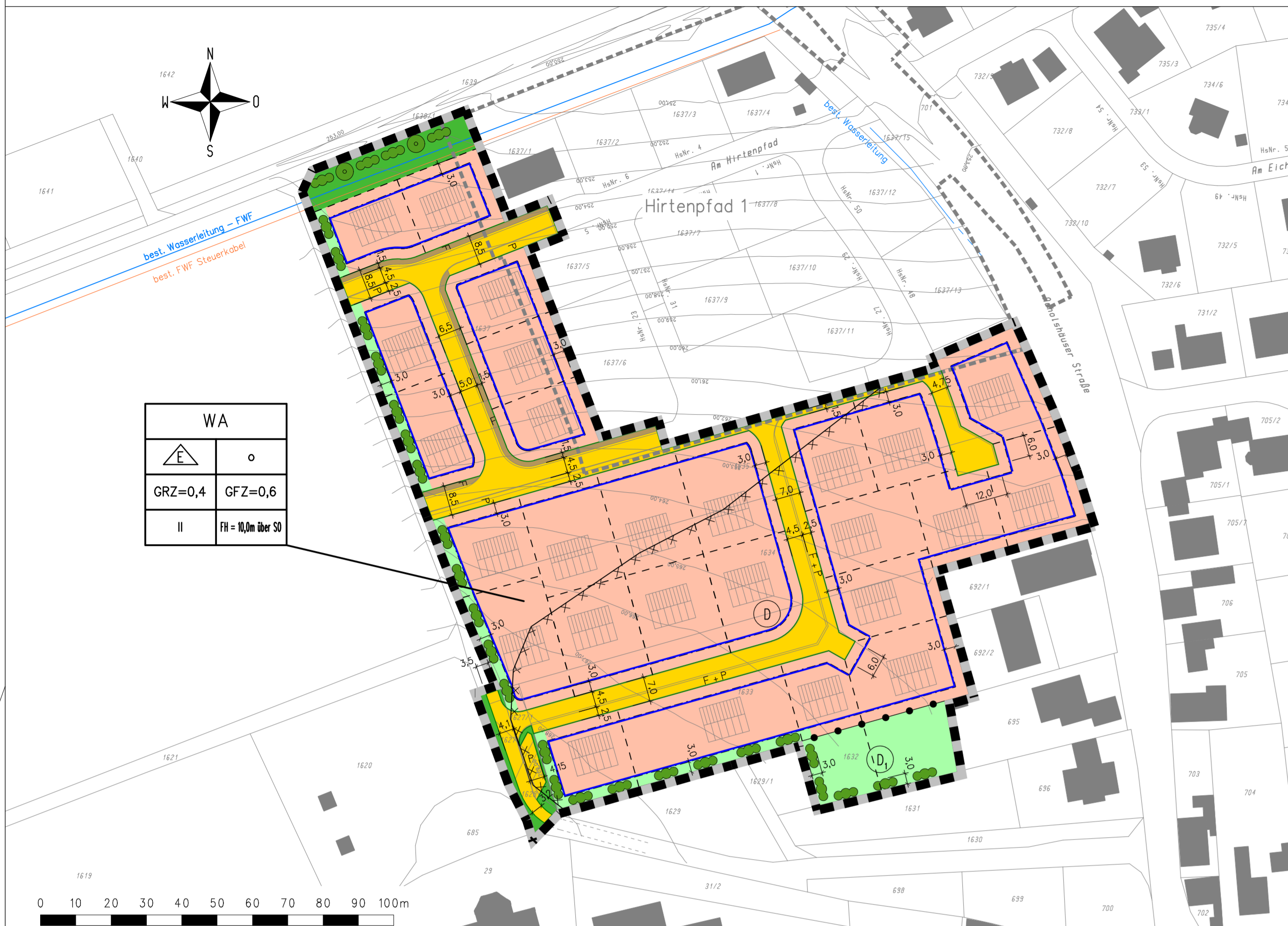

WA table with symbols for building types and height restrictions.



FESTSETZUNGEN GEM. § 9 BauGB UND ART. 81 BayBO

FESTSETZUNGEN DURCH PLANZEICHEN

- List of symbols and their corresponding planning regulations (e.g., WA for residential area, green for public green spaces).

TEXTLICHE FESTSETZUNGEN

- Textual planning regulations covering building use, construction methods, and landscaping requirements.

6 VERKEHRSLÄCHEN

- Regulations regarding traffic areas, including pedestrian crossings and bicycle paths.

7 VER- UND ENTSORGUNG

- Regulations regarding waste management, including disposal and recycling facilities.

8 AUFSCHÜTTUNGEN UND ABGRABUNGEN

- Regulations regarding earthworks, embankments, and excavations.

9 GARAGEN, CARPORTS, STELLPLÄTZE

- Regulations regarding parking spaces, carports, and garages.

10 GRÜNDORNDUNG FÜR ÖFFENTLICHE GRÜNFLÄCHEN UND PRIVATE GRUNDSTÜCKSFLÄCHEN

- Regulations regarding the layout and maintenance of public and private green spaces.

11 MASSNAHMEN ZUM ARTENSCHUTZ

- Regulations regarding nature conservation measures, including species protection and habitat management.

- Regulations regarding landscape protection, including the preservation of existing vegetation and structures.

- Regulations regarding the protection of agricultural areas and farmland.

- Regulations regarding the protection of archaeological sites and historical monuments.

- Regulations regarding the protection of groundwater and water resources.

- Regulations regarding the protection of cultural heritage and historical sites.

- Regulations regarding the protection of the natural environment and landscape.

- Regulations regarding the protection of the climate and energy efficiency.

- Regulations regarding the protection of the landscape and the environment.

- Regulations regarding the protection of the cultural heritage and historical sites.

- Regulations regarding the protection of the natural environment and landscape.

- Regulations regarding the protection of the climate and energy efficiency.

- Regulations regarding the protection of the landscape and the environment.

- Regulations regarding the protection of the natural environment and landscape.

- Regulations regarding the protection of the climate and energy efficiency.

- Regulations regarding the protection of the landscape and the environment.

- Regulations regarding the protection of the natural environment and landscape.

- Regulations regarding the protection of the climate and energy efficiency.

- Regulations regarding the protection of the landscape and the environment.

- Regulations regarding the protection of the natural environment and landscape.

- Regulations regarding the protection of the climate and energy efficiency.

- Regulations regarding the protection of the landscape and the environment.

BEIPLÄNE AUSGLEICHSFLÄCHEN



VERFAHRENSVERMERKE

AUFSTELLUNGSBESCHLUSS: Der Gemeinderat hat in seiner Sitzung am ... die Aufstellung des Bebauungsplanes "Hirtenpfad 2" beschlossen.

ÖFFENTLICHE AUSLEGUNG UND BETEILIGUNG DER BEHÖRDEN UND SONSTIGEN TRÄGER ÖFFENTLICHER BELANGE: Der Bebauungsplanentwurf mit Begründung vom ... in der Fassung vom ... wurde in der Zeit vom ... bis zum ... öffentlich ausgelegt.

SATZUNGSBESCHLUSS: In seiner Sitzung am ... hat der Gemeinderat die während der Auslegungsfrist vorgebrachten Stellungnahmen, Anregungen und Bedenken zur Kenntnis genommen.

BEKANTMACHUNG: Der Satzungsbeschluss wurde durch Mitteilung im Amtsblatt am ... ortsüblich bekannt gemacht (§ 10 Abs. 3 Satz 1 BauGB).

Signature block for the official approval, including the name of the Mayor Johannes Mentth.

Official stamp of the municipality of Gaukönigshofen and the planning department, including contact information for plan2o.

